

# BTV 103

SHUT-OFF VALVES

## BUTTERFLY VALVES



### **WAFER AND FULLY LUGGED VERSION**

*Butterfly valve for heating and cooling systems. Available in pressure class PN 16.*

**TA-SC<sup>®</sup>**

# BTV 103

SHUT-OFF VALVES

## TECHNICAL DESCRIPTION

---

**Applications:**

Heating and cooling systems.

**Function:**

Shut-off

**Dimensions:**

DN 50-600

**Pressure class:**

PN 16

**Temperature:**

Max. working temperature: 120°C

Min. working temperature: -10°C

**Material:**

Body: Ductile iron EN-JS1050

Shaft: Stainless steel BS970 420S37, AISI 420

Disc: Stainless steel BS970 304S15, A351 CF8

Bushing: PTFE

Liner: EPDM

O-rings: EPDM

Lever:

DN 50-150 pressed steel trigger lever, DN 50-600 cast iron gear operator.

**Marking:**

TA-SC, CE, DN and PN.

**Surface treatment:**

Body: FBE (fusion bonded epoxy) coated, dark grey.

Lever and gear operator: FBE (fusion bonded epoxy) coated, black.

**Valve standard:**

According to BS 5155 (EN 593).

**Flanges:**

According to EN 1092-2.

Top flange: According to ISO 5211/1.

# BTV 103

SHUT-OFF VALVES



## Wafer version

### BTV 103WL

With lever

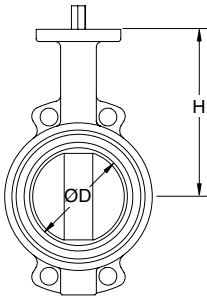

TA No	DN	D	H	Kg*
77 103-050	50	56,8	161	4,5
77 103-065	65	71,5	175	5,4
77 103-080	80	83,0	181	5,6
77 103-090	100	101,5	200	7,6
77 103-091	125	127,8	215	10
77 103-092	150	151,1	225	12

\*) Including lever.

### BTV 103WG

With gear operator

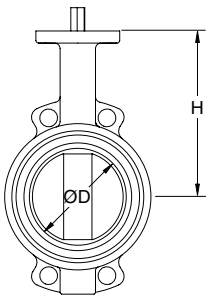

TA No	DN	D	H	Kg**
77 103-250	50	56,8	161	7,9
77 103-265	65	71,5	175	8,8
77 103-280	80	83,0	181	9,0
77 103-290	100	101,5	200	11
77 103-291	125	127,8	215	13
77 103-292	150	151,1	225	16
77 103-293	200	200,5	241	25
77 103-294	250	251,3	296	33
77 103-295	300	300,5	336	45
77 103-296	350	335,5	368	67
77 103-297	400	393,5	400	110
77 103-298	450	443,5	422	131
77 103-299	500	500,5	480	157
77 103-201	600	600,8	562	222

\*\*\*) Including gear operator.

# BTV 103

SHUT-OFF VALVES

## Fully lugged version

### BTV 103FL

With lever

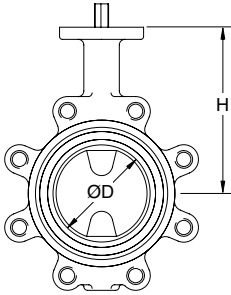

TA No	DN	D	H	Kg*
77 103-150	50	56,8	140	4,6
77 103-165	65	71,5	152	5,6
77 103-180	80	83,0	160	5,9
77 103-190	100	101,5	180	7,8
77 103-191	125	127,8	191	12
77 103-192	150	151,1	202	14

\*) Including lever.

### BTV 103FG

With gear operator

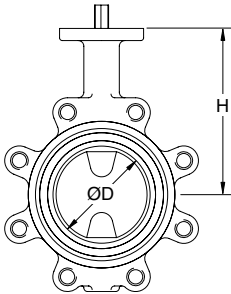

TA No	DN	D	H	Kg**
77 103-350	50	56,8	140	8,0
77 103-365	65	71,5	152	9,0
77 103-380	80	83,0	160	9,3
77 103-390	100	101,5	180	11
77 103-391	125	127,8	191	15
77 103-392	150	151,1	202	17
77 103-393	200	200,5	241	28
77 103-394	250	251,3	274	36
77 103-395	300	300,5	315	47
77 103-396	350	335,5	368	81
77 103-397	400	393,5	400	120
77 103-398	450	443,5	422	145
77 103-399	500	500,5	480	180
77 103-301	600	600,8	562	248

\*\*\*) Including gear operator.

## MEASURES – TRIGGER LEVER AND GEAR OPERATOR

### Lever

The trigger lever is spring loaded and can be locked in a number of positions on ratchet stop plate.

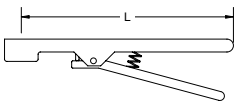

DN	L
50-150	260

### Gear operator

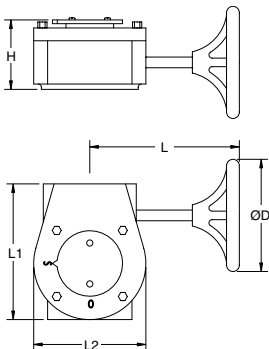

DN	D	L	L1	L2	H
50-150	195	160	130	108	65
200-250	297	238	177	153	85
300-350	297	226	198	161	95
400-450	388	266	281	252	121
500-600	388	241	303	264	118

Tour & Andersson retains the right to make changes to its products and specifications without prior notice.

2-60-20 BTV 103 2008.04

**TA-SC**<sup>®</sup>