



## AVK BALL CHECK VALVE, THREADED, PN10

53/30-005

Ductile iron, DN32-50



AVK ball check valves are self-cleaning and with full bore. The ball rotates during operation eliminating the risk of impurities getting stuck on the ball. The full and smooth bore ensures full flow with low pressure loss and eliminates the risk of deposits at the bottom. AVK ball check valves are available with flanges and internal threads. They are delivered with NBR lined ball as standard and optionally with ball of polyurethane available in different weights.



### Product description:

Ball check valve with BSP threads for wastewater treatment and neutral liquids to max. 70° C

### Standards:

- Designed according to AS4794

### Test/Approvals:

- Hydraulic test according to EN12050-4.
- Approved according to 60143502, TÜV-Mark

### Features:

- Self-cleaning construction, where the ball rotates during operation eliminating the risk of impurities getting stuck on the ball
- Full bore ensures low pressure loss and minimum back pressure
- Smooth bore eliminates the risk of deposits at the bottom
- Ball of aluminium vulcanized with NBR rubber. The rubber hardness is optimised to prevent the ball from getting stuck in the seat.
- The ball is optionally available in polyurethane suitable for abrasive media and if different ball weights are necessary to prevent vibration and water hammer
- Compact design and low weight
- Bolts and nuts of stainless steel and body and cover of ductile iron with epoxy coating internally and externally according to AVK coating standard



Expect ... **AVR**

The designs, materials and specifications shown are subject to change without notice. This is due to the continuous development of our product programme.

# AVK BALL CHECK VALVE, THREADED, PN10

53/30-005

Ductile iron, DN32-50

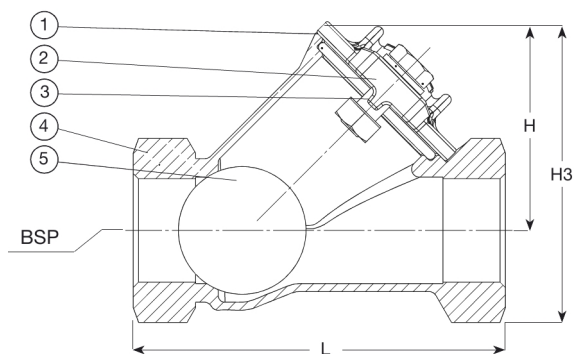

DN 32

DN 40

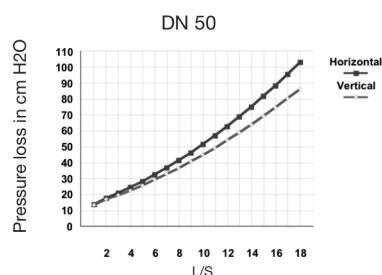
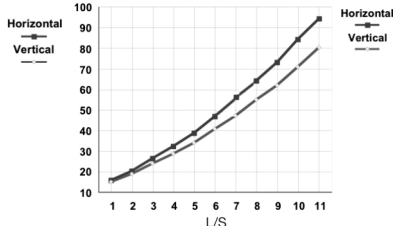
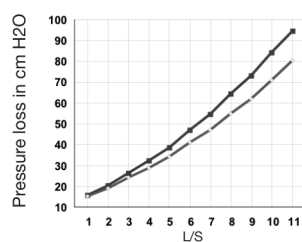

## Component list:

1. Cover	Ductile iron GJS-500-7 (GGG-50)	4. Body	Ductile iron GJS-500-7 (GGG-50)
2. Bolt/nut/washer	Stainless steel A2	5. Ball	Aluminium with NBR-liner
3. Gasket	NBR rubber		

Components may be substituted with equivalent or higher class materials without prior notification.

## Reference nos. and dimensions:

AVK ref. no.	DN mm	Product PN Class	L mm	H mm	H3 mm	Int. pipe thread ISO 228 G	Theoretical weight/kg
53-032-30-9007	32	PN10	140	83	118	1 1/4"	2.0
53-040-30-9007	40	PN10	140	83	118	1 1/2"	2.0
53-050-30-9007	50	PN10	180	101	144	2"	3.0

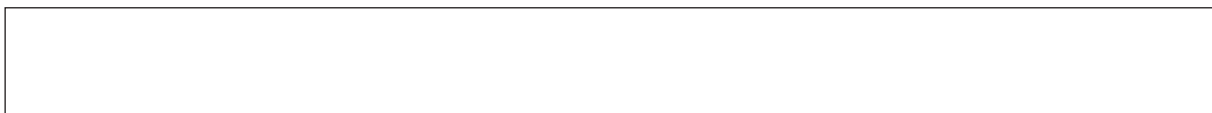

**Use:**

For water and sewage to max. 70°C.  
PUR balls max. 50°C.

**Options:**

Ball of polyurethane for special applications

**Materials:**

**Standard balls:**

Core (hollow) NBR rubber line on a metal core

**PUR balls:**

Core (solid) Polyurethane

**O-rings:**

NBR



**O-rings between bonnet and body**

Part no.	Check valve	Diameter
1520025	DN 32/40	ø53,75 x ø3,53
010623	DN 50	ø70 x ø4,5
9610005959	DN 65	ø687,2 x ø5,7
010624	DN 80	ø104,14 x ø5,33
010625	DN 100	ø134,2 x ø5,7
010626	DN 125/150	ø189,87 x ø6,99
010627	DN 200	ø260 x ø8
9610001141	DN 250	ø320 x ø8
9610001142	DN 300	ø380 x ø10
9610001143	DN 350	ø440 x ø10
010631	DN 400	ø510 x ø10
9610000335	DN 500	ø700 x ø12
9610000336	DN 600	ø830 x ø14

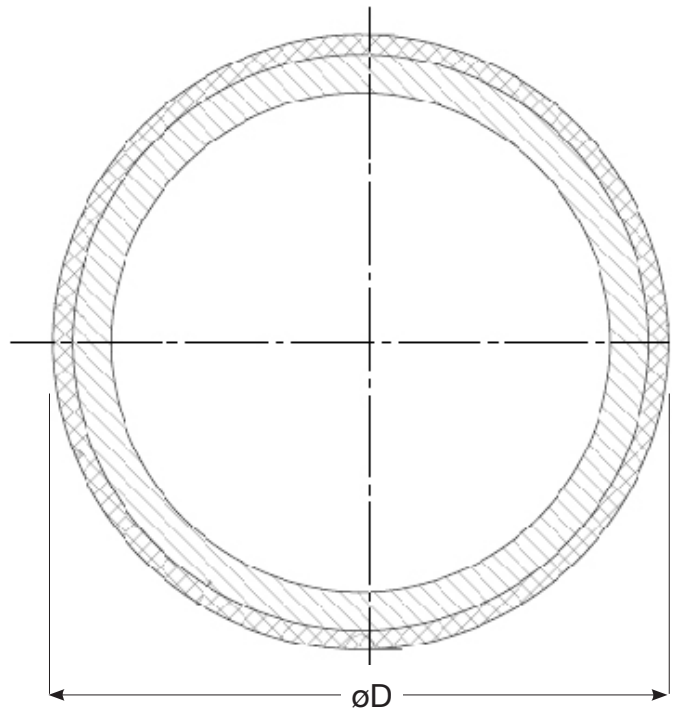

**Standard rubber lined balls (NBR) with standard weights**

Part no.	Check valve	Diameter øD	Weight g
53-048-150	DN 32/40	48	127
53-060-150	DN 50	60	226
53-080-150	DN 65	80	427
53-095-150	DN 80	95	628
53-120-150	DN 100	120	1266
53-175-150	DN 125/150	175	3928
53-240-150	DN 200	240	9400
53-300-150	DN 250	300	17700
53-360-150	DN 300	360	30000
53-420-150	DN 350	420	48000
53-480-150	DN 400	480	72000

**PUR floating balls**

Part no.	Check valve	Diameter øD	Weight g
53-048-055	DN 32/40	48	48
53-060-055	DN 50	60	90
53-080-055	DN 65	80	184
53-095-055	DN 80	95	350
53-120-055	DN 100	120	561
53-175-055	DN 125/150	175	2200
53-240-055	DN 200	240	5500
53-300-055	DN 250	300	10800
53-360-055	DN 300	360	18400
53-420-055	DN 350	420	30000
53-480-055	DN 400	480	45000

**PUR balls with standard weights**

Part no.	Check valve	Diameter øD	Weight g
53-048-050	DN 32/40	48	127
53-060-050	DN 50	60	226
53-080-050	DN 65	80	328
53-095-050	DN 80	95	628
53-120-050	DN 100	120	1266
53-175-050	DN 125/150	175	3928
53-240-050	DN 200	240	9400
53-300-050	DN 250	300	17700
53-360-050	DN 300	360	30000
53-420-050	DN 350	420	48000
53-480-050	DN 400	480	72000

**PUR balls with 20% heavier weights**

Part no.	Check valve	Diameter øD	Weight g
53-048-052	DN 32/40	48	144
53-060-052	DN 50	60	256
53-080-052	DN 65	80	394
53-095-052	DN 80	95	807
53-120-052	DN 100	120	1628
53-175-052	DN 125/150	175	5505
53-240-052	DN 200	240	11300
53-300-052	DN 250	300	21300
53-360-052	DN 300	360	36000
53-420-052	DN 350	420	57000
53-480-052	DN 400	480	86000

**PUR balls with 20% lighter weights**

Part no.	Check valve	Diameter øD	Weight g
53-048-054	DN 32/40	48	114
53-060-054	DN 50	60	203
53-080-054	DN 65	80	252
53-095-054	DN 80	95	565
53-120-054	DN 100	120	1139
53-175-054	DN 125/150	175	3535
53-240-054	DN 200	240	8460
53-300-054	DN 250	300	15930
53-360-054	DN 300	360	27000
53-420-054	DN 350	420	43200
53-480-054	DN 400	480	64800

\* Weight tolerance +/- 5%