

NEPOVRATNI VENTIL, SWING, PRIROBNIČNI / SWING CHECK VALVE

// Delovna temperatura / Working temperature: 0 °C / +120 °C

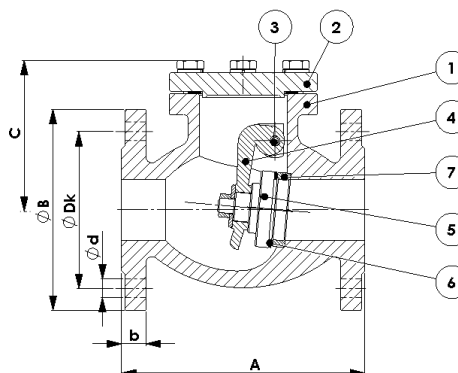

Materiali / Materials

1	Ohišje Body	Siva litina – EN-GJL-250 (GG25) Cast Iron – EN-GJL-250 (GG25)	5	Disk Disc	Siva litina – EN-GJL-250 (GG25) Cast Iron – EN-GJL-250 (GG25)
2	Pokrov Bonnet	Siva litina – EN-GJL-250 (GG25) Cast Iron – EN-GJL-250 (GG25)	6	Tesnilo diska Disc ring	EPDM
3	Os Hanger pin	Medenina Brass	7	Tesnilo ohišja Body ring	Medenina Brass
4	Nosilec diska Hanger	Nodularna litina – EN-GJS-400-15 (GGG40) Ductile Iron – EN-GJS-400-15 (GGG40)			

PN16

Art.	DN	A	ØB	b	C	ØDK	n-Ød	Teža / Weight [kg]
A031146	40	180	150	18	118	110	4-18	11,5
A030846	50	200	165	20	120	125	4-18	13,6
A031147	65	240	185	20	125	145	4-18	21,0
A031148	80	260	200	22	147	160	8-18	26,5
A030855	100	300	220	24	158	180	8-18	32,0
A030854	125	350	250	26	188	210	8-18	45,0
A030853	150	400	285	26	193	240	8-23	71,5
A030852	200	500	340	30	250	295	12-23	95,0
A031548	250	600	405	32	300	355	12-27	139,0
A031549	300	700	460	32	342	410	12-27	193,0

Opombe

Vgradna dolžina ustreza standardu EN558-1 serija 48 (DIN3202 F6).

Notes

Face to face dimensions conform to EN558-1 Series 48 (DIN3202 F6).